

## Bluebirds Across Nebraska

# Gilbertson Conduit/Rebar Mounting System

Bluebirds Across Nebraska believes the Gilbertson conduit/rebar mounting system is the best system available for mounting a lightweight bluebird box. This system was developed by longtime bluebirder Steve Gilbertson, Atkin, Minn., in the late '80's. Thousands of boxes have been successfully mounted on this system by bluebirders in Nebraska, Minnesota and many other parts of the country.

The conduit/rebar system is almost 100 percent predator proof. For added protection, the conduit can be rubbed with course steel wool and a coating of carnauba car wax or furniture polish can be applied. This should be done at the beginning of the nesting season.

This system can be easily used on any of the three nest boxes BAN distributes – the Gilbertson PVC, the Troyer, and the Gilwood.

### Materials:

**CONDUIT:** Use 1/2-inch EMT electrical conduit (available in 10-foot lengths). The Gilwood and Troyer boxes require a piece 4 1/2 feet long, while the PVC requires a 5 foot length. Using these lengths places the boxes at a height for easy monitoring.

**REBAR:** Use a piece of 1/2-inch rebar with a minimum length of 4 foot. Sandy or loose soil may require a 5' rebar, 3' in the ground. The rebar must be cut, not sheared. Shearing will create a bur on the end of the rebar which will prevent the conduit from slipping over it.

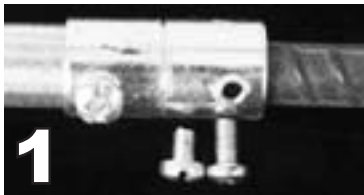
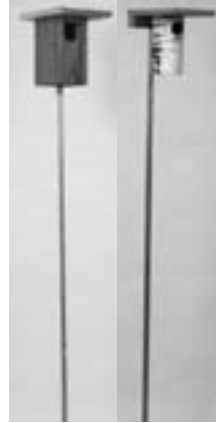

**CONDUIT COUPLER:** Use a 1/2-inch conduit coupler. The bottom screw provided with the coupler will have to be replaced by a slightly longer screw in order for the conduit to make contact with the rebar (See image 1). This will keep the conduit from twisting on the rebar.

Using a hammer, drive the rebar approximately two feet into the ground (See image 2).



Place the conduit with the coupler attached over the rebar and tighten until snug. Do not over tighten as the coupler can crack (See image 3).



Place the box over the conduit with the entrance hole facing the desired direction. A 47/64" hole is provided on the underside of the roof of the PVC and on the base of the extended back of the Troyer box. The Gilwood box has a conduit coupler attached to the base of the box (See image 4).

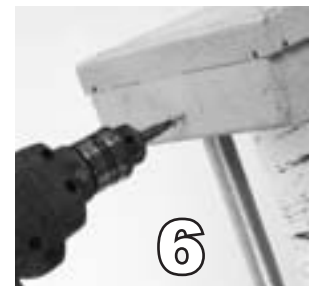
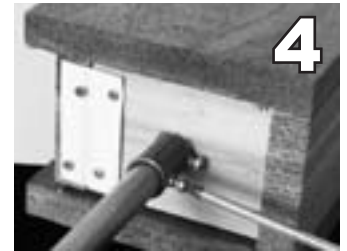

Use a cordless drill and screw a self-tapping screw to secure a Troyer (See image 5) or PVC box (See image 6) to the conduit. To use a conventional screw, the hole must be pre-drilled. A screw driver is all that is needed to attach a Gilwood box to the conduit.

In addition to providing superior predator protection, the conduit/rebar system has the benefit of being easy to move or remove as your trail needs dictate and it can be made or purchased for a reasonable price. After a period of time, the rebar may rust into the ground and a pair of vice grips may be needed to remove it (See image 7).

